

High Pressure Black Steel Manifold Components

Application:

For use in high pressure vapour LPG gas manifold systems.

Specifications:

- Hardened High carbon steel
- High pressure: 3000lb
- Designed, manufactured and approved to:
 - EN 10204 3.1
 - ISO 9001

Installation:

Black Steel is liable to surface rust and must be painted to avoid corrosion as per AS/NZS 5601.

Female 90 degree Elbow (GMFE15):

- Thread: 1/2" NPT
- A: 33mm
- B: 38mm

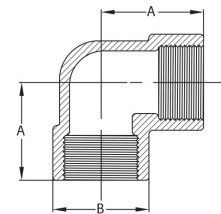

Hex Nipple (GMFN15):

- Thread: 1/2" NPT
- A: 47mm
- C: 24mm

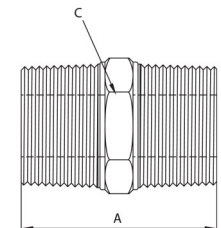

Hex Plug (GMFP15):

- Thread: 1/2" NPT
- A: 22mm
- B: 22mm

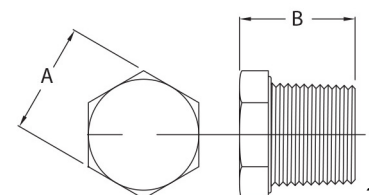

Spec Sheet

Female Equal Tee (GMFT15):

- Thread: 1/2" NPT
- A: 38mm
- B: 66mm

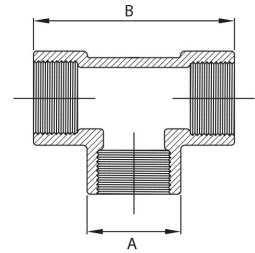

3pce Union (GMFU15):

- Thread: 1/2" NPT
- A: 27.7mm
- B: 49mm

